

# PAX-0200



## **Introduction :**

The **PAX-0200** Linear Actuator is a compact, high-performance device with a 1500N push force and ultra-quiet operation below 42 dB. Built with durable metal and stroke limit switches, it's ideal for medical, industrial, and automotive applications, delivering reliable and precise motion control.

## **Key Feature :**

- Powerful linear actuator with 1500N push and 1400N pull force.
- Operates quietly below 42 dB with built-in stroke limit switches for safety.
- Durable metal housing, compact design, and available in various stroke lengths.
- Perfect for medical, industrial, and automotive applications.



**Specification :**

<b>Model</b>	PAX-0200
<b>Material</b>	Metal
<b>Voltage</b>	DC 12V/24V/36V/48VDC
<b>Maximum Push/Pull Force</b>	Approx. 150kg/140kg
<b>Stroke Length (Optional)</b>	50mm, 100mm, 150mm, 250mm, 300mm
<b>No-load Speed</b>	6mm/s
<b>Speed and Pull Relationship</b>	5mm/s(kg) / 50s(50kg)
<b>Environment Temperature</b>	-26°C to +50°C
<b>Protection Level</b>	IP54
<b>Built-in Stroke Switch</b>	Yes
<b>Color</b>	Silver
<b>Weight</b>	723g(50mm), 846g(100mm), 947g(150mm), 1136g(250mm), 1215g(300mm)

**Applications :**

- Automotive: Electric sunroof, electric lifting lever, electric booth
- Medical Devices: Electric beds (surgical, traction, medical), electric wheelchair
- Engineering Industry: Industrial electric lifting systems, agricultural machinery
- Furniture: Electric sofas

**Drawing :**

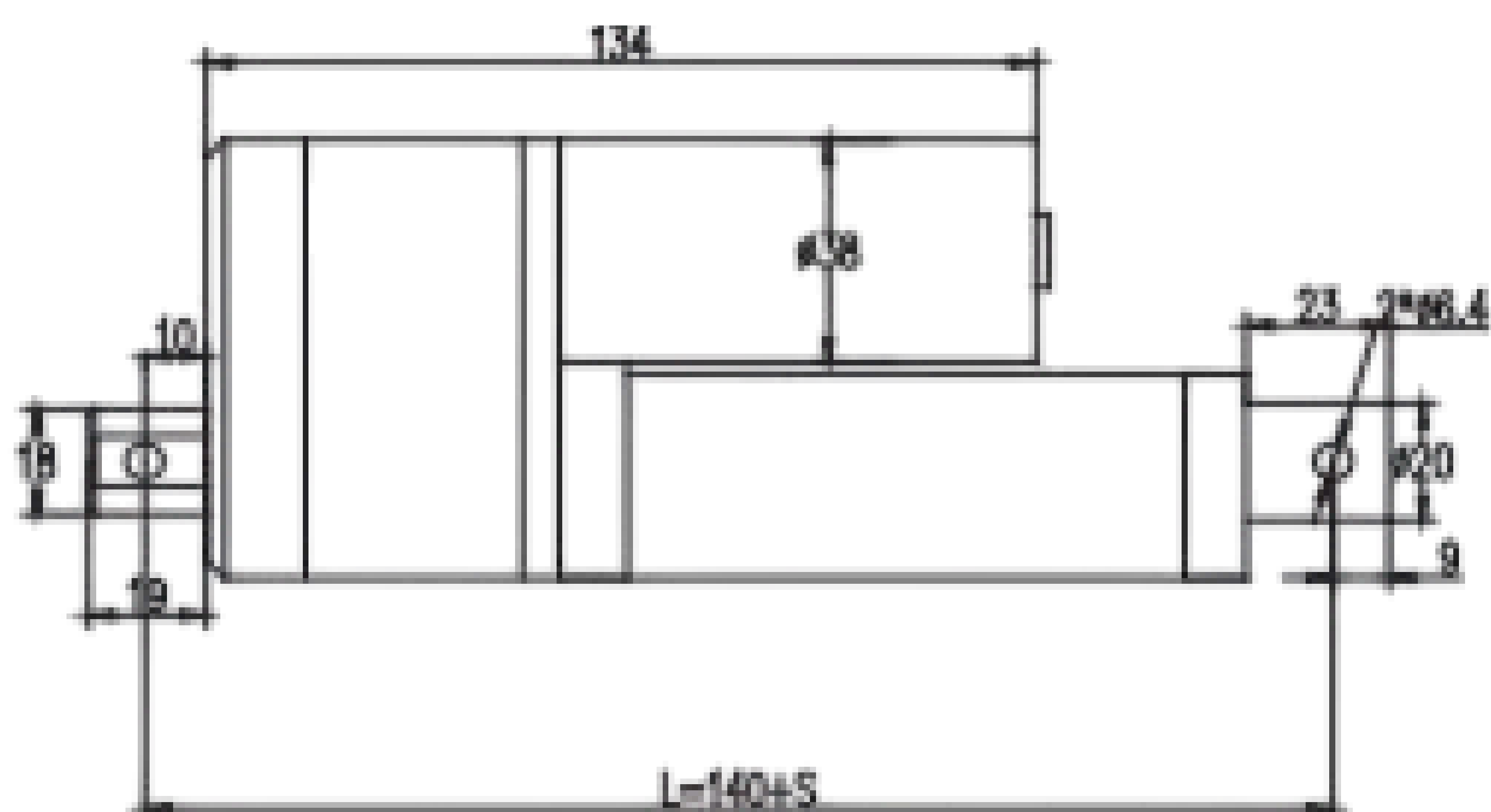
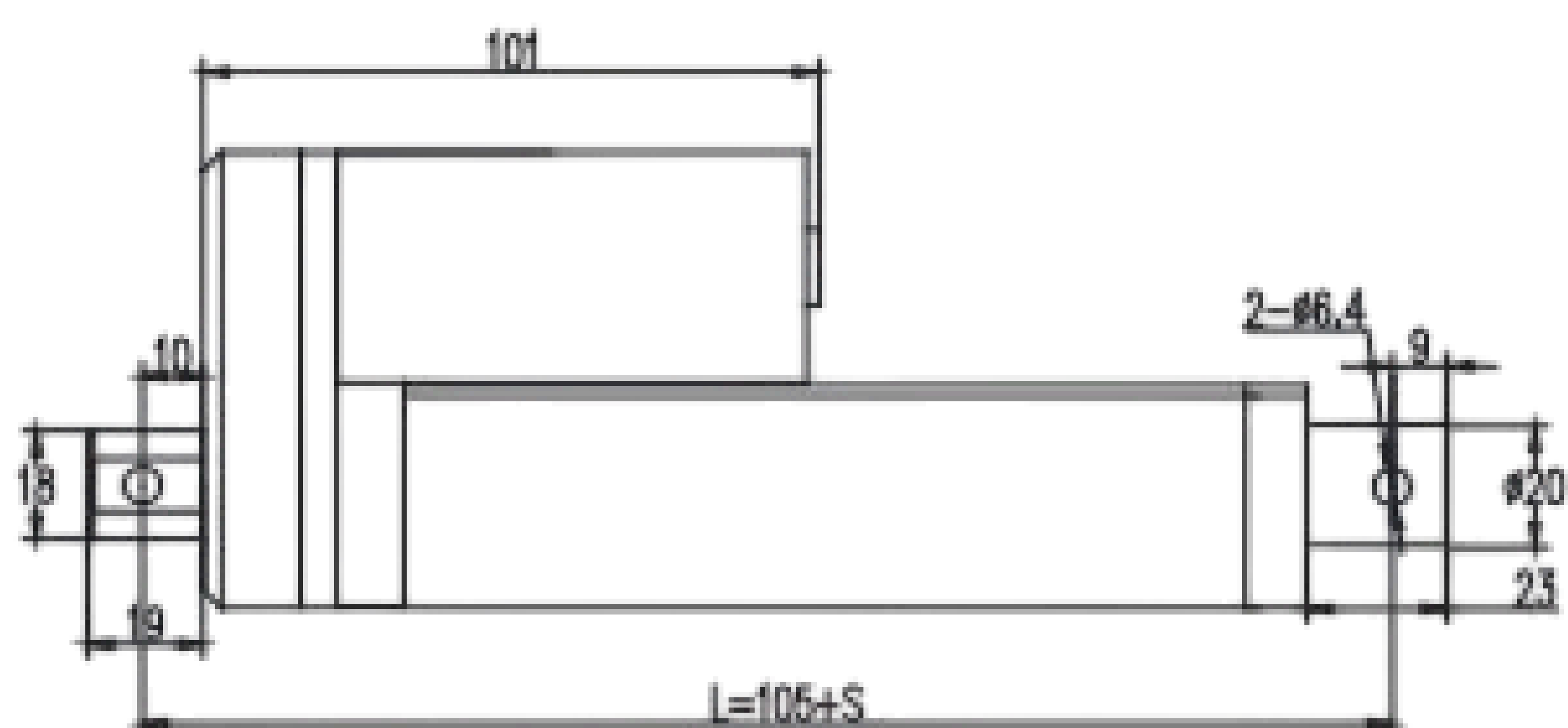
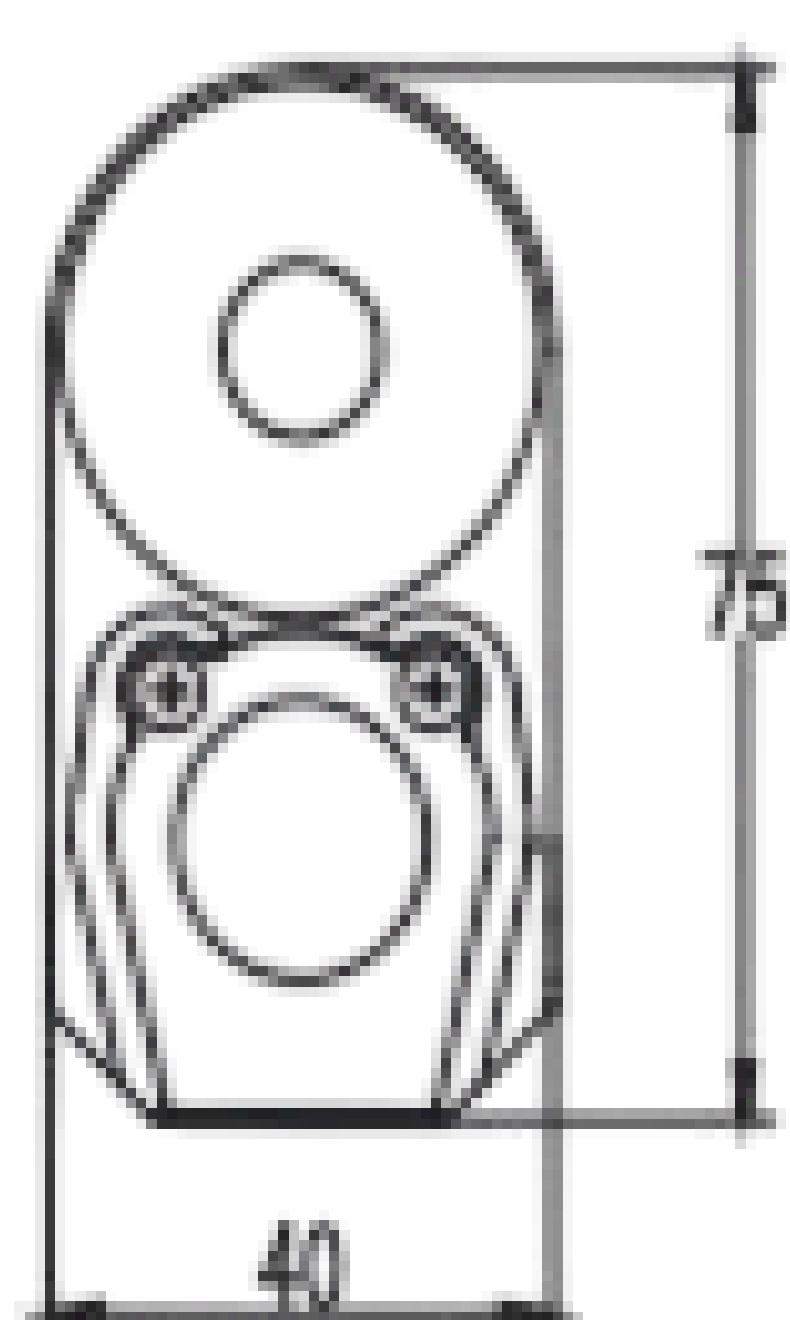



## **Product Detail :**



**Stroke Range :**

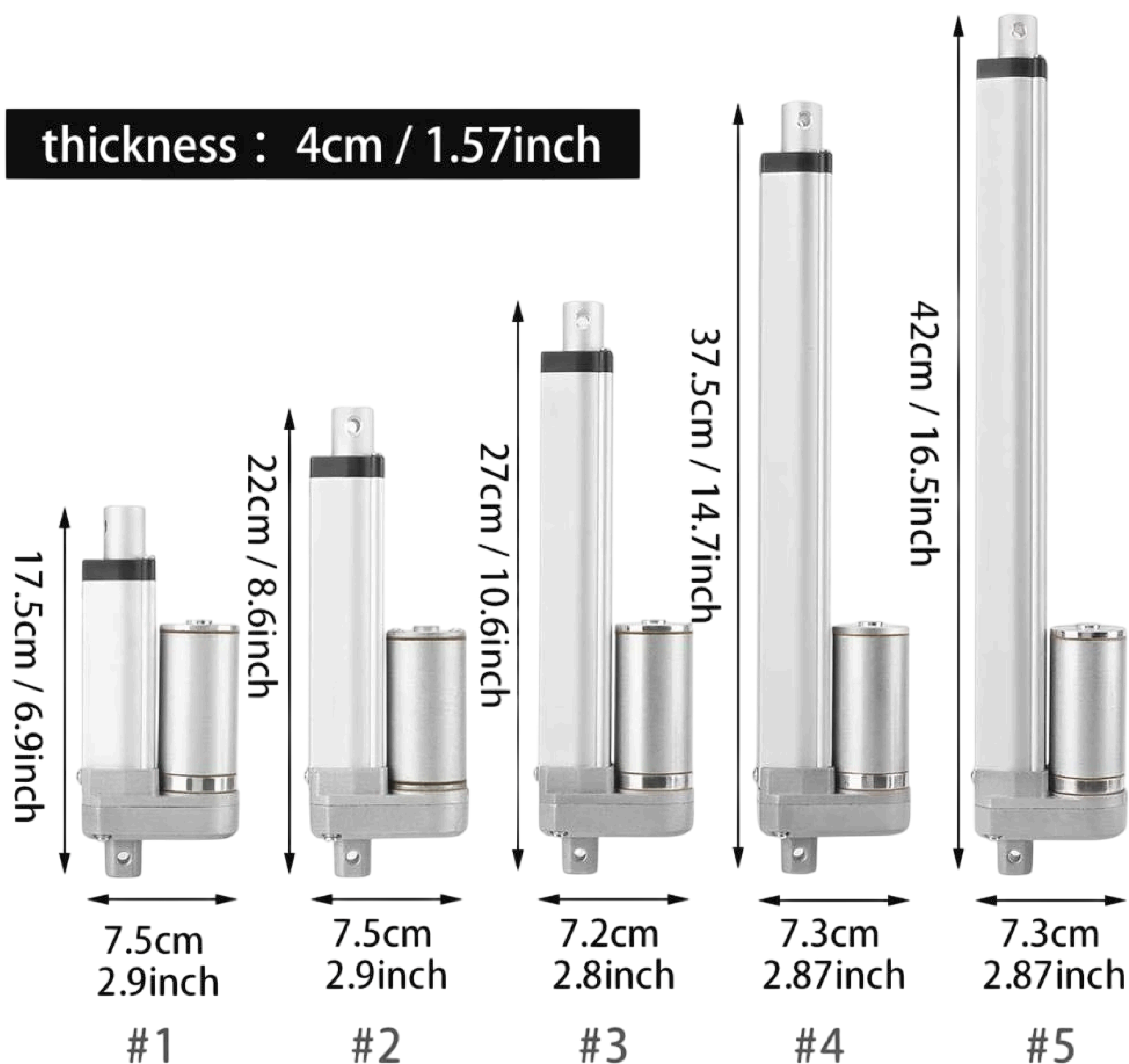



***Product Detail :***



***Product Detail :***

