

PAX-1200



Introduction :

The **PAX-1200** Linear Actuator is a powerful, low-noise solution built for heavy-duty industrial applications. With high load capacity, multiple voltage options, and customizable stroke lengths, it delivers precise and reliable linear motion. Ideal for operations demanding strength, stability, and quiet performance.

Key Feature :

- *High Load:* Handles up to 12,000N for heavy-duty use.
- *Multi-Voltage:* Supports 12V, 24V, 36V, and 48V DC.
- *Flexible Stroke:* Standard and customizable stroke lengths.
- *Quiet Operation:* Runs below 60 dB for minimal noise.
- *Limit Switches:* Built-in for accurate stroke control.
- *Robust Build:* Durable design for tough environments.



Specification :

Model	PAX-1200
Input Voltage	12VDC / 24VDC / 36VDC / 48VDC
Maximum Load	12,000N (approximately 1,200kg)
Stroke Lengths	25mm, 50mm, 100mm, 150mm, 200mm, 250mm, 300mm (customizable)
Noise Level	≤ 60 dB
Limit Switches	Built-in
Duty Cycle	10% (2 minutes operation, 18 minutes rest)
Operating Temperature	-20°C to +45°C
Color	Black
Installation Size	Stroke length + 250mm

Applications :

- Home Automation
- Renewable Energy
- Medical Equipment
- Agriculture
- Industrial & Engineering
- Furniture
- Specialty Systems

Drawing :

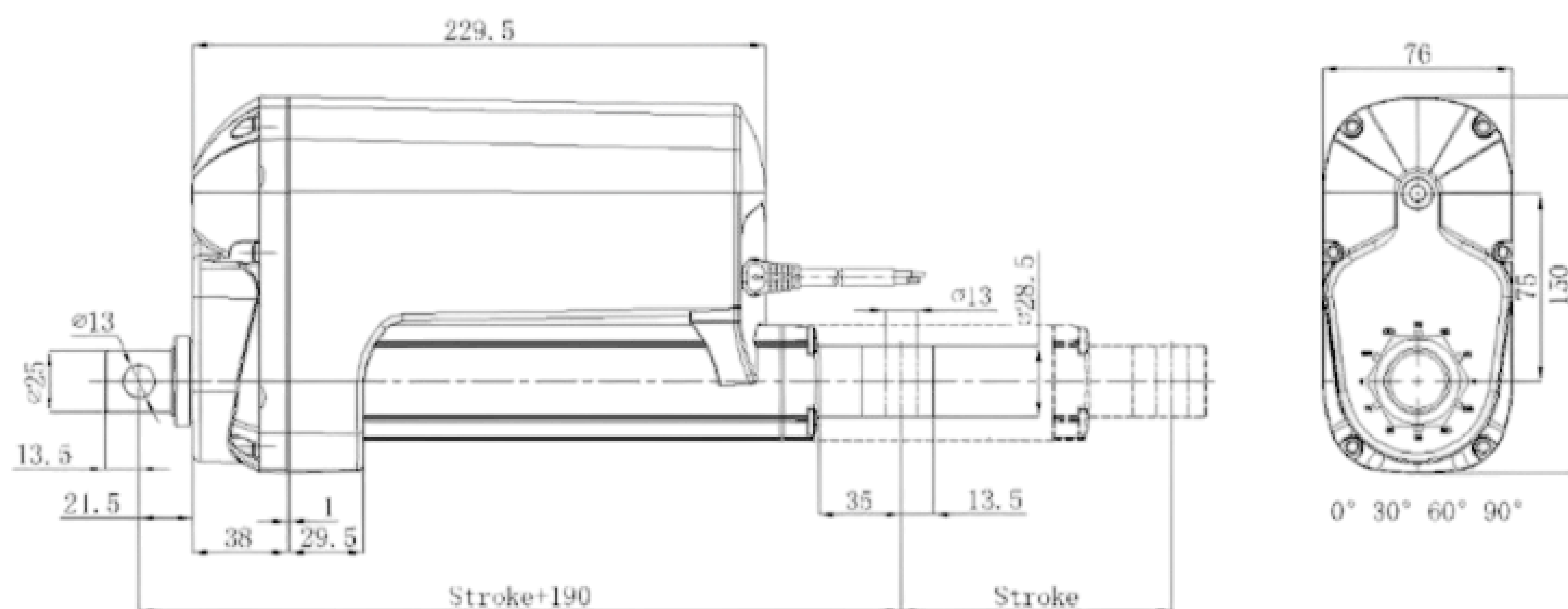
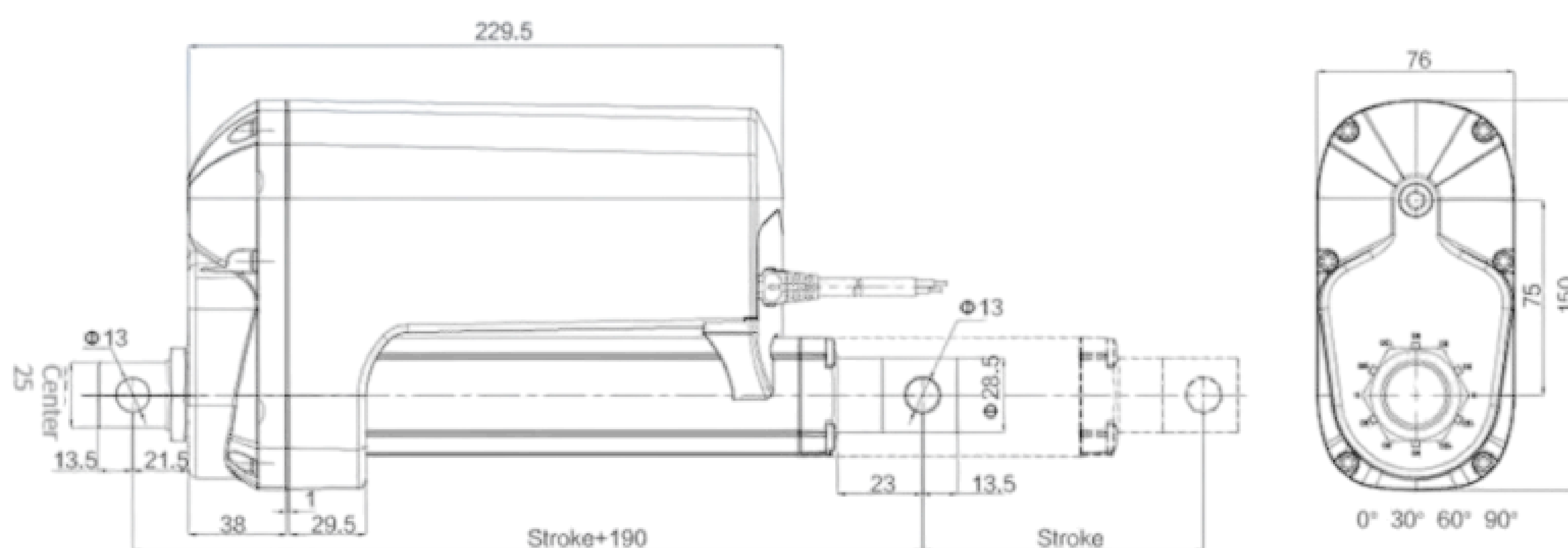

(The angle in front of the illustration above is in the 0° direction)

Product Detail :



Product Detail:

